

PORT OF TACOMA FILE: N:\2018\1800249 POT PCT Culvert Repair\Drawings\Current\201070 - C1.1-C1.2 (SITE PLAN)

MATCH LINE SEE SHEET C1.2

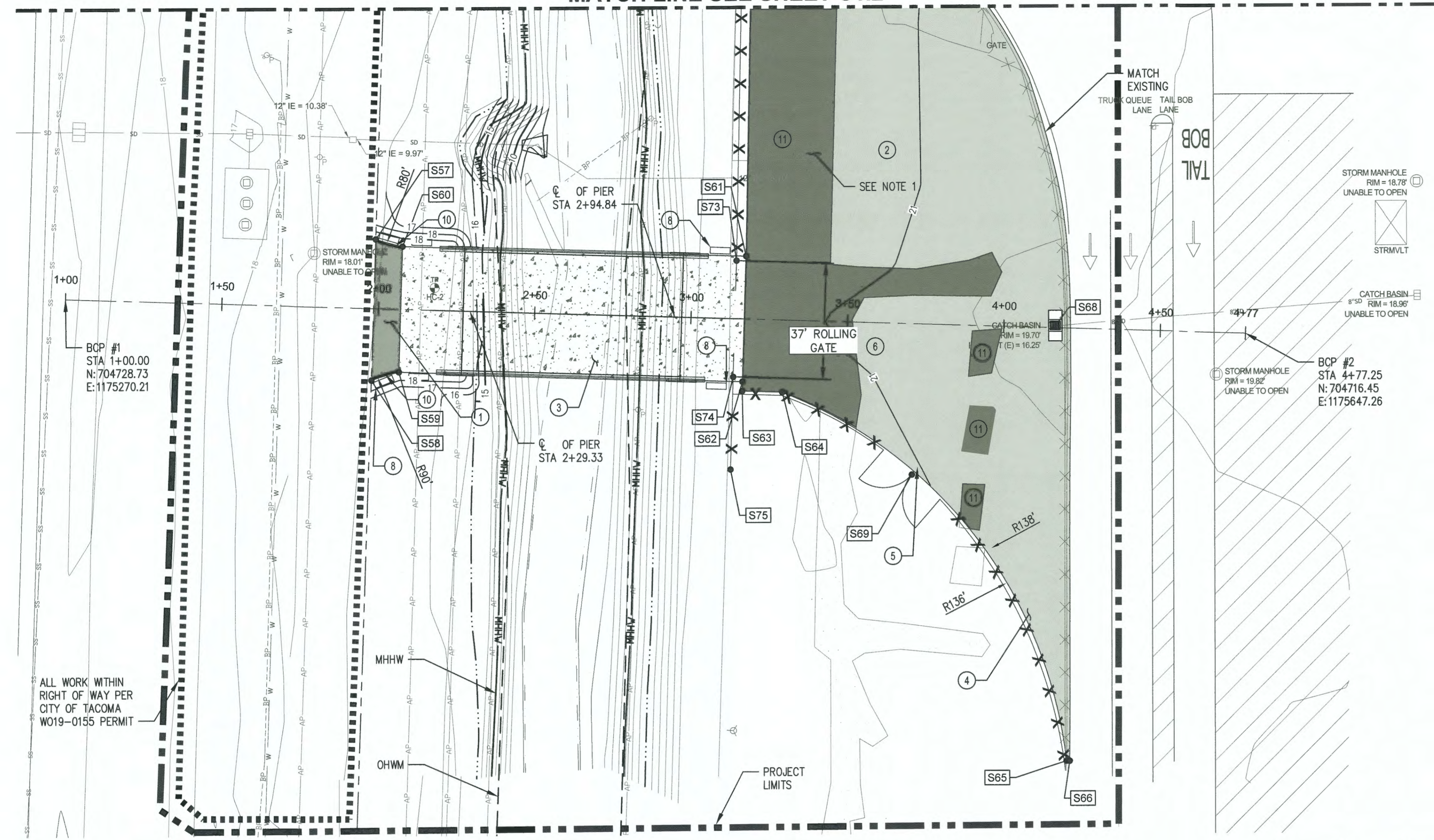

SITE NOTES

1. EXPOSED GRAVEL AREAS REQUIRE BASE PREPARATION PER PAVING DETAIL 6 ON SHEET C1.3.
2. CONTRACTOR TO COORDINATE WITH TACOMA POWER (TPU) FOR POWER VAULT RELOCATION. TPU TO TEMPORARILY DE-ENERGIZE SUPPLY TO VAULT. CONTRACTOR SHALL RELOCATE UNDERGROUND POWER AND REQUEST TPU TO RECONNECT. POWER OUTAGE SHALL BE COORDINATED WITH THE PORT, WITH 10 DAYS NOTICE AND APPROVAL REQUIRED PRIOR TO BEGINNING WORK.
3. POWER VAULT IS A 223 SSB VAULT WITH A 120 VOLT PHASE 1 3 WIRE 100AMP WITH 100 MAIN BREAKER PANEL. 2" CONDUIT FROM TPU POLE #2286 IS ROUTED INTO EX. VAULT WITH (1)2"C-(3)2# CU AND (1)#8 CU GRD ROUTED OUT OF THE VAULT.
4. NEW CONDUIT TO BE INSTALLED PER PLAN AND SHALL BE SCHEDULE 80 PVC.
5. METALLIC CONDUITS, COUPLINGS, AND JOINTS OF METALLIC CONDUITS EMBEDDED IN CONCRETE, CDF, EARTH, OR ASPHALT SHALL BE 1/2 LAP TAPED OR OTHERWISE MADE WATERTIGHT TO PREVENT INTRUSION OF MORTAR, WATER, OR OTHER MATERIALS.
6. ALL CONDUIT SHOWN IS BELOW GRADE. SEE DETAIL 1 ON SHEET C1.2 FOR TRENCHING REQUIREMENTS.

KEYNOTES

- 1 6" HMA OVER 8" BASECOURSE
- 2 4" HMA OVERLAY OVER EXISTING ASPHALT
- 3 CONCRETE SURFACE, SEE S1.2
- 4 8-FT BLACK VINYL COATED FENCE (NIC)
- 5 24-FT DOUBLE SWING GATE, SEE DETAIL 1 ON SHEET C1.3 (NIC)
- 6 37-FT MANUAL ROLLING GATE, SEE DETAIL 2 ON SHEET C1.3 (NIC)
- 7 RELOCATED ELECTRICAL VAULT. SEE SITE NOTES 2 THROUGH 6.
- 8 EVENLY PLACE ECOLOGY BLOCKS STOCKPILED FROM DEMOLITION ON EACH SIDE OF DRIVEWAY - 14 TOTAL (NIC)
- 9 INSTALL NEW UNDERGROUND CONDUIT. SEE SITE NOTES 4 THROUGH 6.
- 10 HMA WEDGE CURB, SEE DETAIL 1 ON SHEET C1.1
- 11 4" HMA OVER GRAVEL

ALL WORK WITHIN RIGHT OF WAY PER CITY OF TACOMA W019-0155 PERMIT

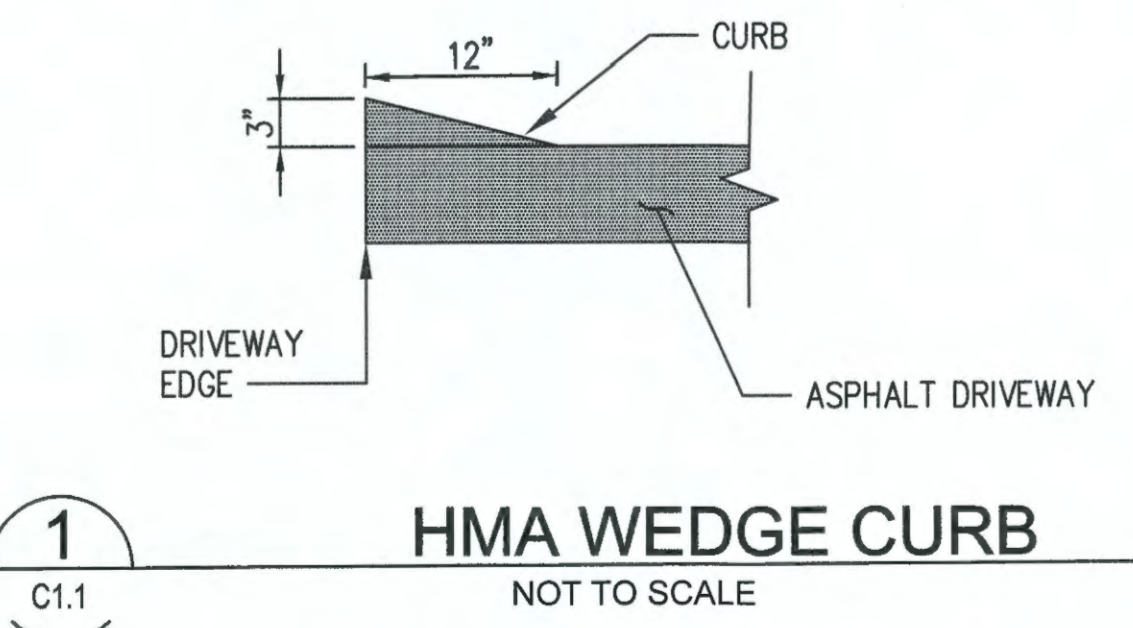

POINT	NORTHING	EASTING	DESCRIPTION
S57	704747.57	1175369.43	EDGE OF PAVEMENT
S58	704702.67	1175367.87	EDGE OF PAVEMENT
S59	704705.25	1175376.67	EDGE OF PAVEMENT
S60	704745.23	1175377.97	EDGE OF PAVEMENT
S61	704741.65	1175487.74	EDGE OF PAVEMENT
S62	704701.68	1175486.44	EDGE OF PAVEMENT
S63	704698.68	1175486.34	EDGE OF PAVEMENT
S64	704698.26	1175499.15	EDGE OF PAVEMENT
S65	704580.60	1175589.73	EDGE OF PAVEMENT
S66	704580.59	1175590.73	EDGE OF PAVEMENT
S68	704719.08	1175586.52	TREATMENT VAULT
S69	704671.88	1175540.50	DOULBE SWING GATE
S73	704740.24	1175484.68	ROLLING GATE
S74	704703.26	1175483.49	ROLLING GATE
S75	704673.79	1175482.53	FENCE

LEGEND

- 1 6-INCH HMA PAVEMENT
- 2 4-INCH HMA OVERLAY OVER EXISTING PAVEMENT
- 11 4-INCH HMA OVER GRAVELED AREAS
- CONCRETE BRIDGE DECK
- X X FENCE (NIC)
- BP UNDERGROUND POWER
- ORDINARY HIGH WATER MARK
- MHHW MEAN HIGHER HIGH WATER
- PROJECT LIMITS
- LIMITS OF R.O.W. WORK
- 4 C1.3 6-INCH HMA OVER 8" BASECOURSE
- 5 C1.3 4-INCH HMA OVERLAY OVER EXISTING ASPHALT
- 6 C1.3 4-INCH HMA OVER GRAVELED AREAS

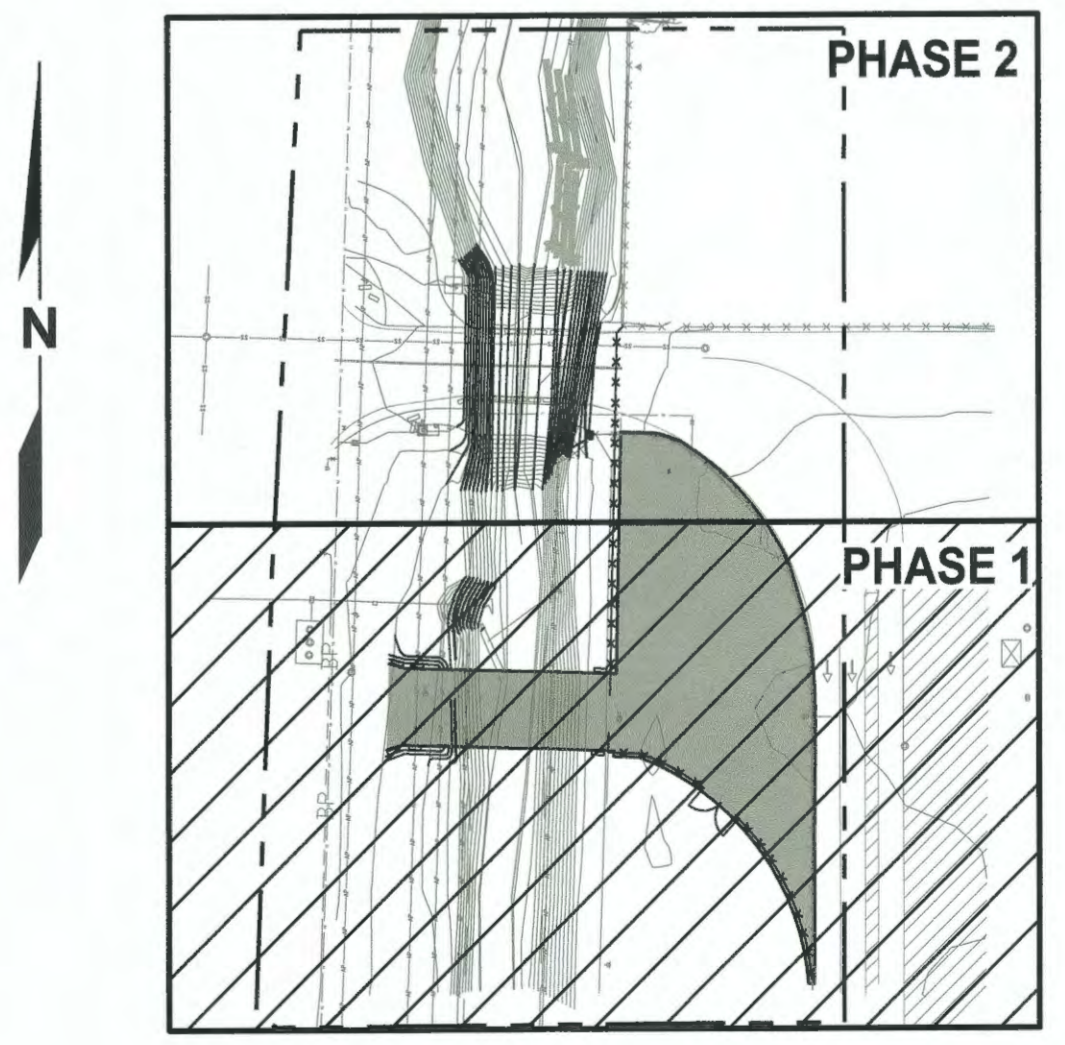
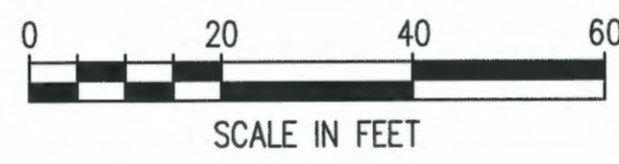

Port of Tacoma
2407 North 31st Street, Suite 100
Tacoma, WA 98401
(253) 396-0150 Fax (253) 396-0162

kpff
Kiewit Professional Firm, Inc.
2407 North 31st Street, Suite 100
Tacoma, WA 98401
(253) 396-0150 Fax (253) 396-0162

APPROVED:

DIRECTOR

CMB 06/01/20

CHECKED BY: DATE

SWK 06/01/20

PROJ. ENGR. DATE

rlambert Jun 17, 2020

PORT ADDRESS: ONE SITCUM PLAZA
TACOMA, WA 98401-1837

6608

C1.1

10 OF 33

CONTRACT: 071198

TOWNSHIP: 20N

RANGE: 08E

SECTION: 01

M. ID: 201070.01

DAT-HRZ: WA83-SF

VERT: MLLW 19.18' @ TIDE 22-1933

PHASE: BID SET

PARCEL: 15

DRAWING SCALE: AS SHOWN

WAPATO CREEK

BRIDGE AND CULVERT REMOVAL

CIVIL/SITE PLAN

PHASE 1

THIS DRAWING IS THE PROPERTY OF THE PORT OF TACOMA AND SHALL NOT BE USED ON OTHER WORK, DISCLOSED, COPIED, IN WHOLE OR IN PART, WITHOUT WRITTEN PERMISSION

BINDING EDGE

PORT OF TACOMA FILE: N:\2018\1600249 POT PCT Culvert Repair\Drawings\Current\201070 - C1.3 (SITE DETAILS)

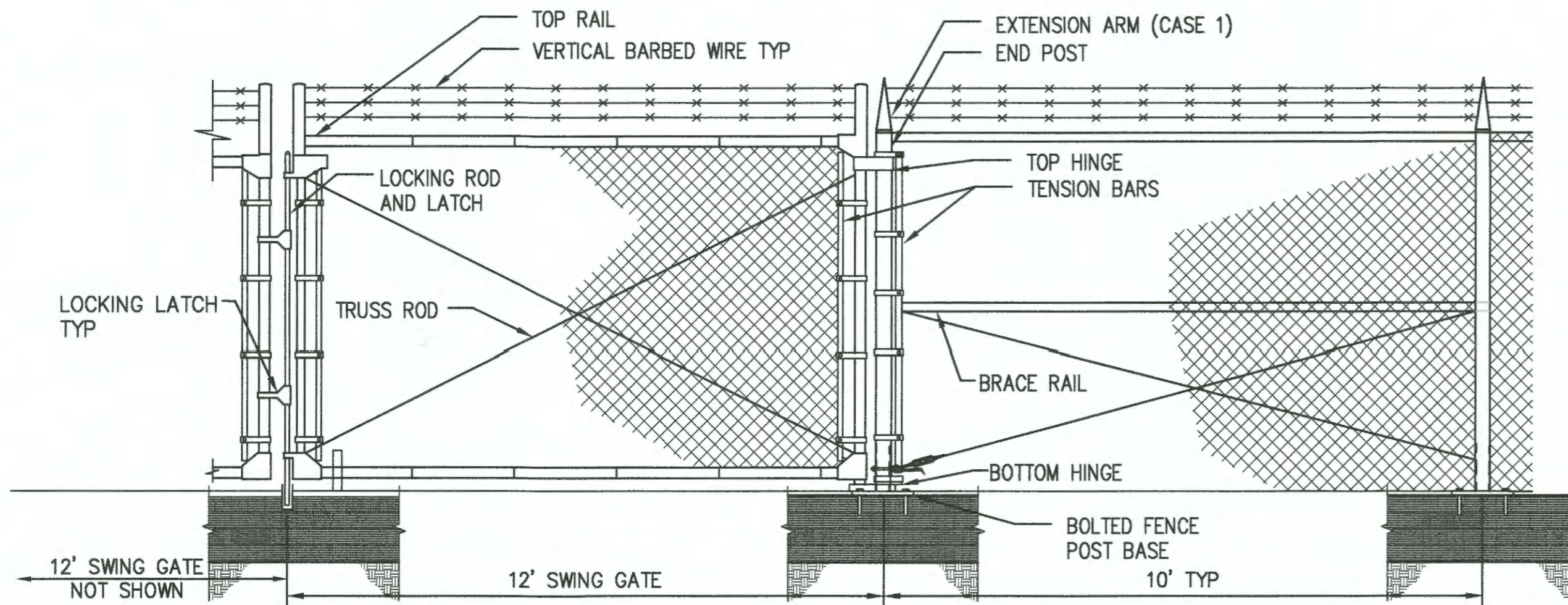

24-FT DOUBLE SWING GATE (NIC)
NOT TO SCALE

GENERAL NOTES

- BLACK VINYL FENCE FABRIC SHALL BE SALVAGED FROM FENCE IDENTIFIED ON D1.1 AND D1.2 BY PORT MAINTENANCE. PORT MAINTENANCE SHALL REINSTALL FABRIC WITH NEW FENCE POSTS WHERE APPROPRIATE.
- VERTICAL BARBED WIRE AND EXTENSION ARMS SHALL BE SALVAGED FROM FENCE IDENTIFIED ON D1.1 AND D1.2 BY PORT MAINTENANCE. PORT MAINTENANCE SHALL REINSTALL.

CONCRETE FOUNDATION DIMENSIONS			
LOCATION	a	b	c
CORNER	12"	6"	4'-6"
END	12"	6"	4'-6"
GATE	18" + POST OD	6"	4'-6"
LINE & OTHER	10"	6"	3'-6"
SLOPED CONDITION	12"	6"	5'-6"

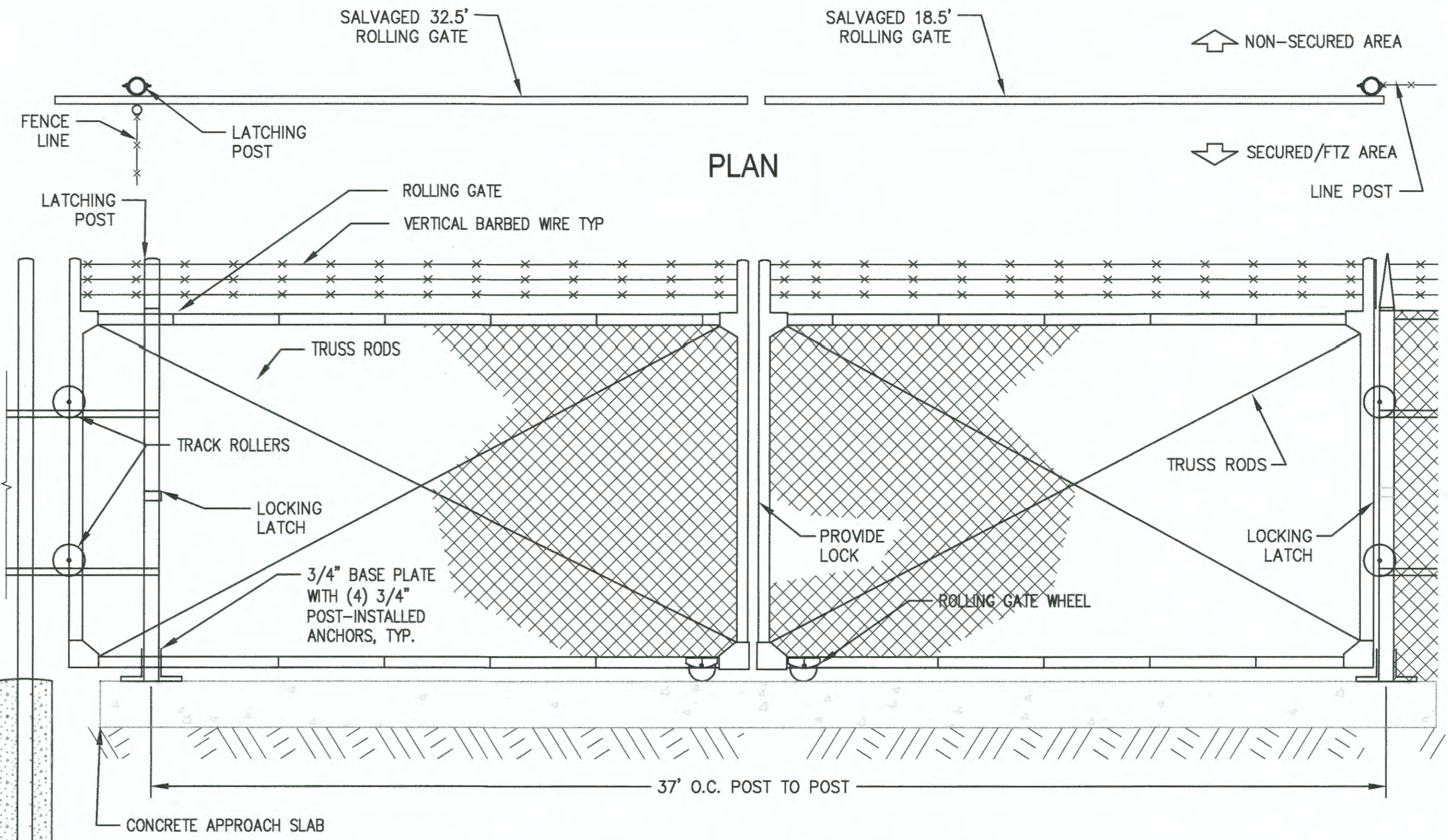

37-FT ROLLING GATE (NIC)
NOT TO SCALE

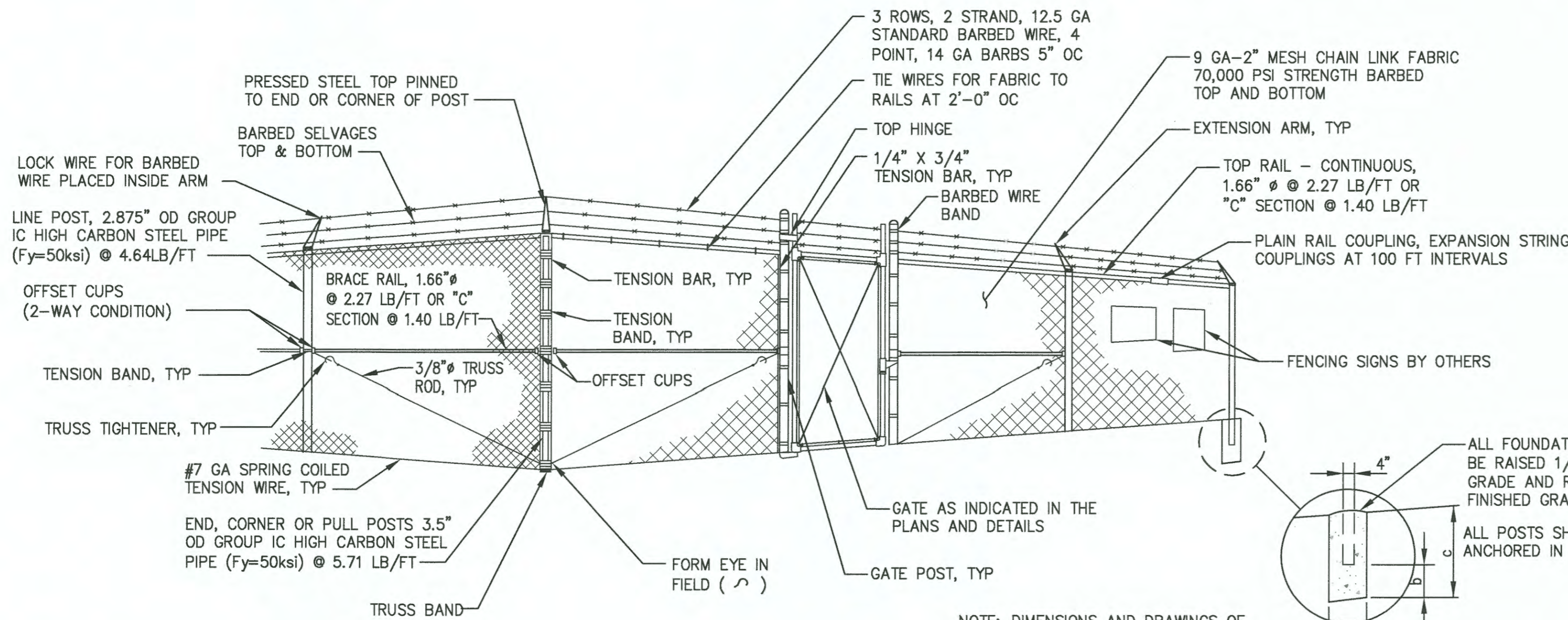

CHAINLINK FENCE DETAIL (NIC)
NOT TO SCALE

NOTE: DIMENSIONS AND DRAWINGS OF CHAIN LINK FENCE ARE PROVIDED FOR REFERENCE ONLY.

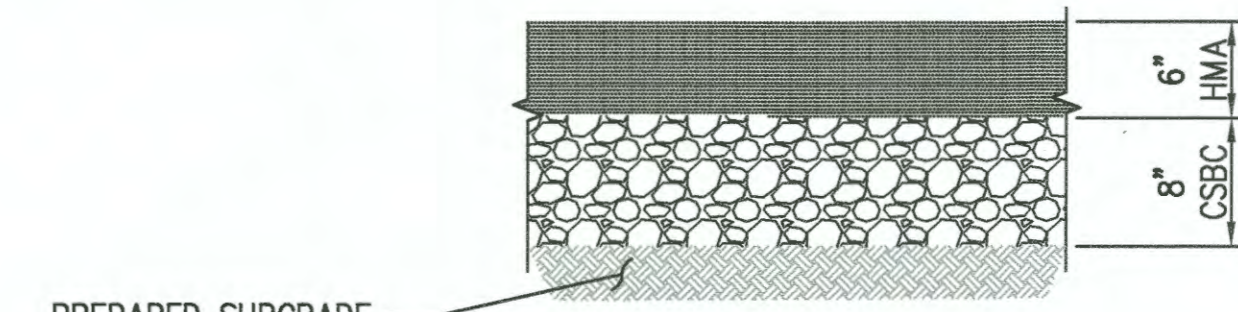

NEW ASPHALT PAVEMENT DETAIL
NOT TO SCALE

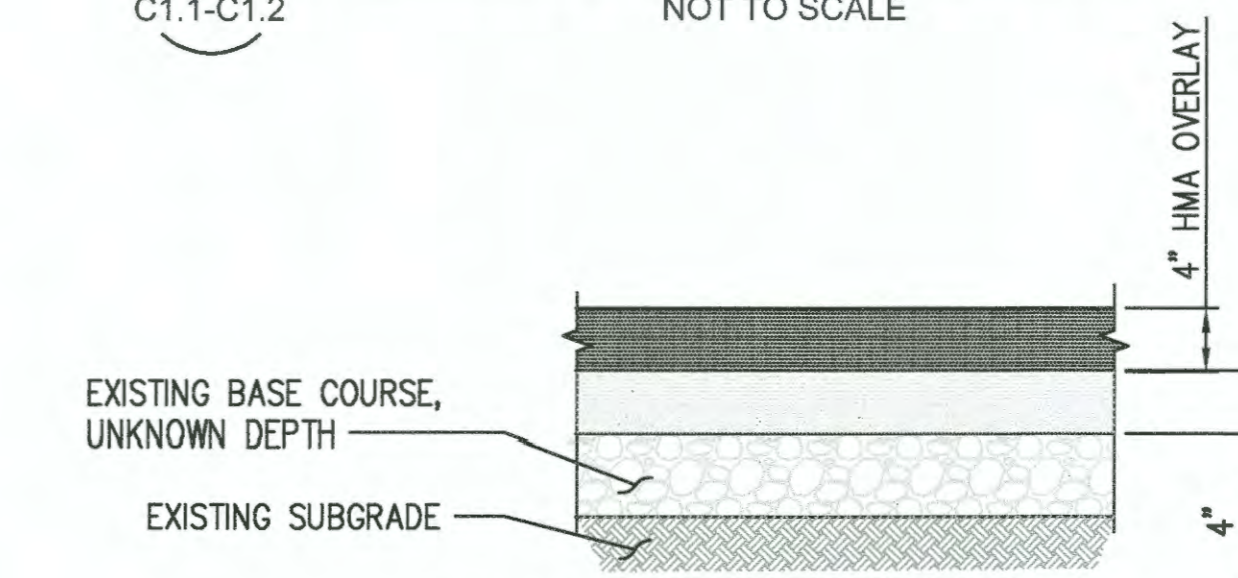

ASPHALT PAVEMENT OVERLAY DETAIL
NOT TO SCALE

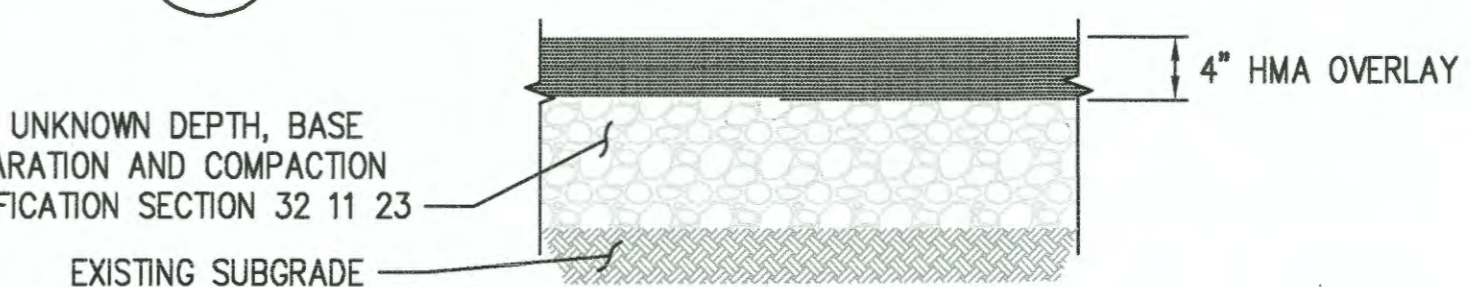

ASPHALT PAVEMENT OVER GRAVELED AREAS
NOT TO SCALE

2407 North 34th Street, Suite 100
Tacoma, WA 98401-1837
Tel: (253) 396-0150 Fax: (253) 396-0162

2407 North 34th Street, Suite 100
Tacoma, WA 98401-1837
Tel: (253) 396-0150 Fax: (253) 396-0162

DATE: _____

APPR: _____

BY: _____

REVISION: _____

DATE: 06/01/20

DATE: 06/01/20

DATE: Jun 17, 2020

DATE: AS SHOWN

DATE: _____

DATE: _____

DATE: _____

DATE: _____

DATE: _____

DATE: _____

DATE: _____

DATE: _____

CMB: SWK

CHECKED BY: SWK

APPROVED:

PROJECT: WAPATO CREEK BRIDGE AND CULVERT REMOVAL

PROJECT ENGINEER: Robert J. Lambert

PRINTED BY: rjambert

PORT ADDRESS: ONE SITCUM PLAZA

TACOMA, WA 98401-1837

SECTION: 01

RANGE: 20N

TOWNSHIP: 20N

DAT-HRZ: WA83-SF

PARCEL: 15

SCALE: AS SHOWN

DRAWING SCALE: AS SHOWN

6608

C1.3

12 OF 33

WAPATO CREEK BRIDGE AND CULVERT REMOVAL

CIVIL/SITE DETAILS

CONTRACTOR: 071198

M. ID: 201070.01

PHASE: BID SET

THIS DRAWING IS THE PROPERTY OF THE PORT OF TACOMA AND SHALL NOT BE USED ON OTHER WORK, DISCLOSED, COPIED, IN WHOLE OR IN PART, WITHOUT WRITTEN PERMISSION

MATCH LINE SEE SHEET C2.2

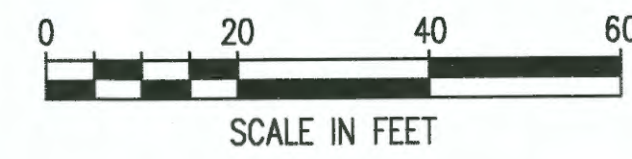
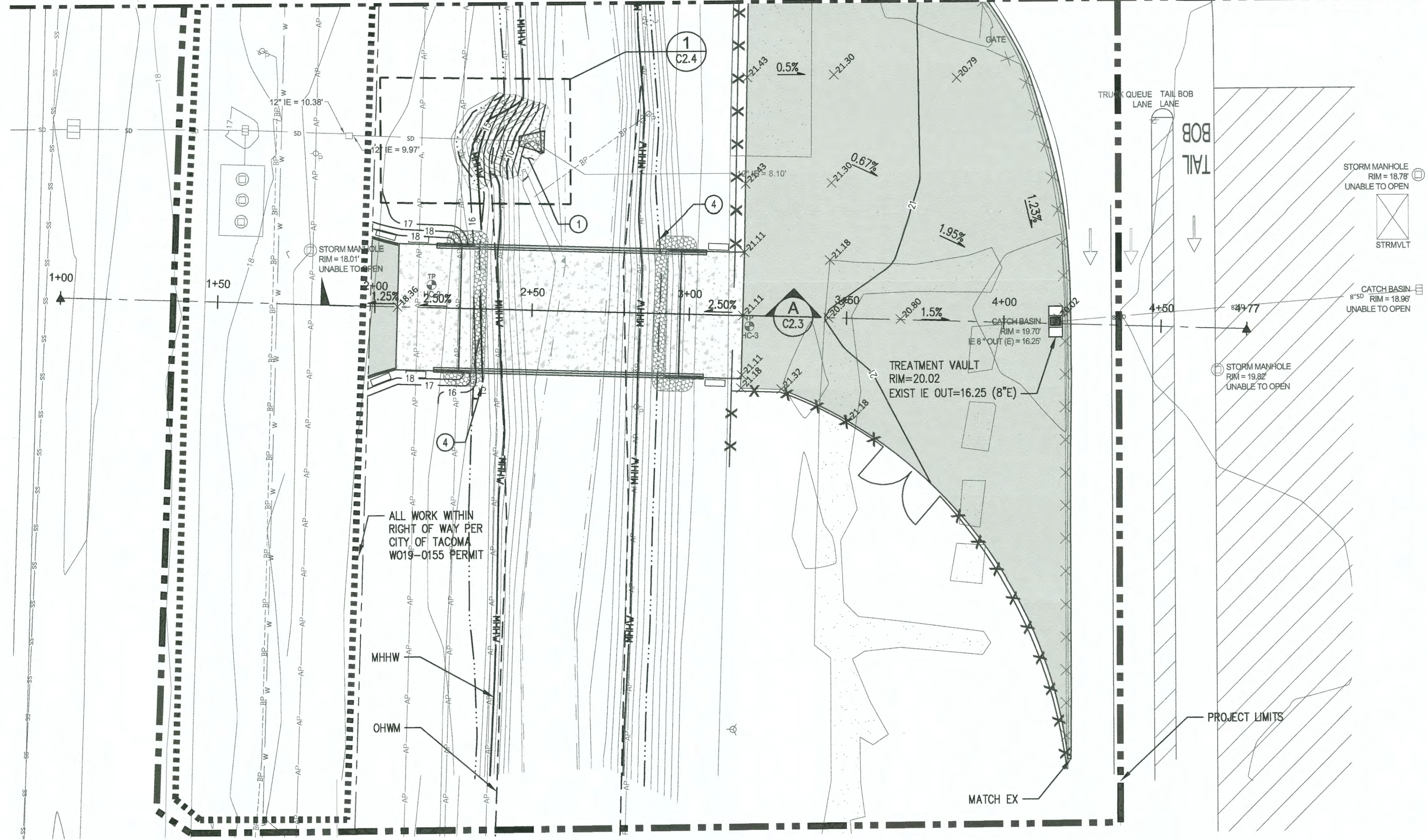

GRADING AND DRAINAGE NOTES

1. SITE GRADING SHALL BE COORDINATED AROUND TIDAL INFLUENCE TO BEST MINIMIZE EROSION.
2. CONTRACTOR SHALL COORDINATE ELECTRICAL VAULT RELOCATION WITH TPU PRIOR TO BEGINNING SITE GRADING.

KEYNOTES

- 1 PLANTED WILLOW STAKES, SEE DETAIL 1 ON C2.5
- 2 RIPRAP BLANKET AND ROCK TOE PROTECTION
- 3 CLEAN, ROUNDED 3-INCH MINUS GRAVEL
- 4 2-MAN BOULDERS
- 5 LARGE WOODY MATERIAL SHALL BE BETWEEN 30 AND 45 FEET LONG AND BETWEEN 2 AND 2.5 FEET IN DIAMETER, INSTALLED PER DETAIL B ON C2.5

LEGEND

- PLANTED WILLOW STAKES 1 C2.5
- RIPRAP / BOULDERS
- CLEAN, ROUNDED 3-INCH MINUS GRAVEL
- PROPOSED GRADE
- ORDINARY HIGH WATER MARK
- MEAN HIGHER HIGH WATER
- PROPOSED HMA
- PROPOSED CONCRETE
- PROJECT LIMITS
- RIGHT OF WAY LIMITS

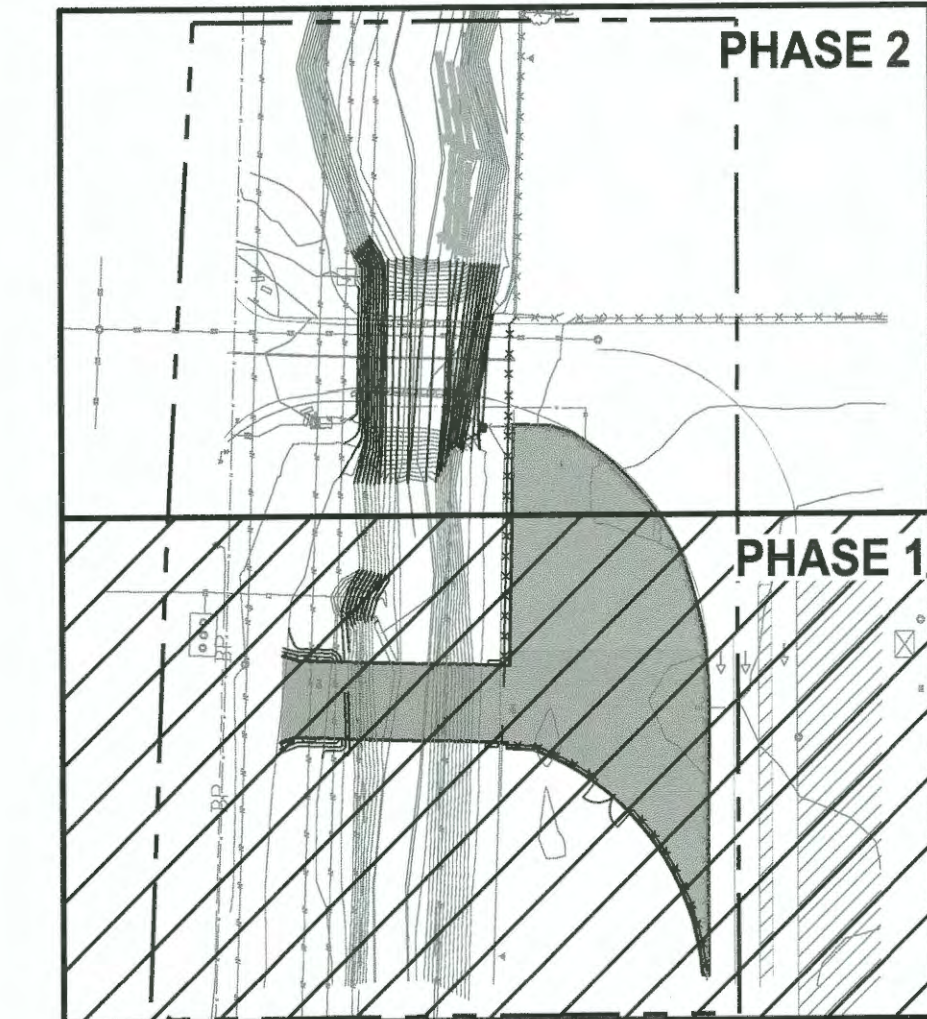

2457 North 31st Street, Suite 100
Tacoma, Washington 98407
(253) 396-0150 fax (253) 396-0162



APPROVED:

CMB 06/01/20
CHECKED BY: SWK 06/01/20
DIRECTOR ENGR. DATE: Jun 17, 2020
PROJECT ENGR. DATE: Jun 17, 2020
PORT ADDRESS: ONE SITCUM PLAZA
TACOMA, WA 98401-1837

6608
C2.1
13 OF 33

WAPATO CREEK
BRIDGE AND CULVERT REMOVAL
GRADING AND DRAINAGE PLAN
PHASE 1

TOWNSHIP: 20N RANGE: 03E SECTION: 01
DATE: 201070.01 DAT-HRZ: WA83-SF VERT: MLLW 19.18 @ TIDE 22.1933
PARCEL: 15 DRAWING SCALE: AS SHOWN

CONTRACTOR: 071198
M. ID: 201070.01
PHASE: BID SET

THIS DRAWING IS THE PROPERTY OF THE PORT OF TACOMA AND SHALL NOT BE USED ON OTHER WORK, DISCLOSED, COPIED, IN WHOLE OR IN PART, WITHOUT WRITTEN PERMISSION

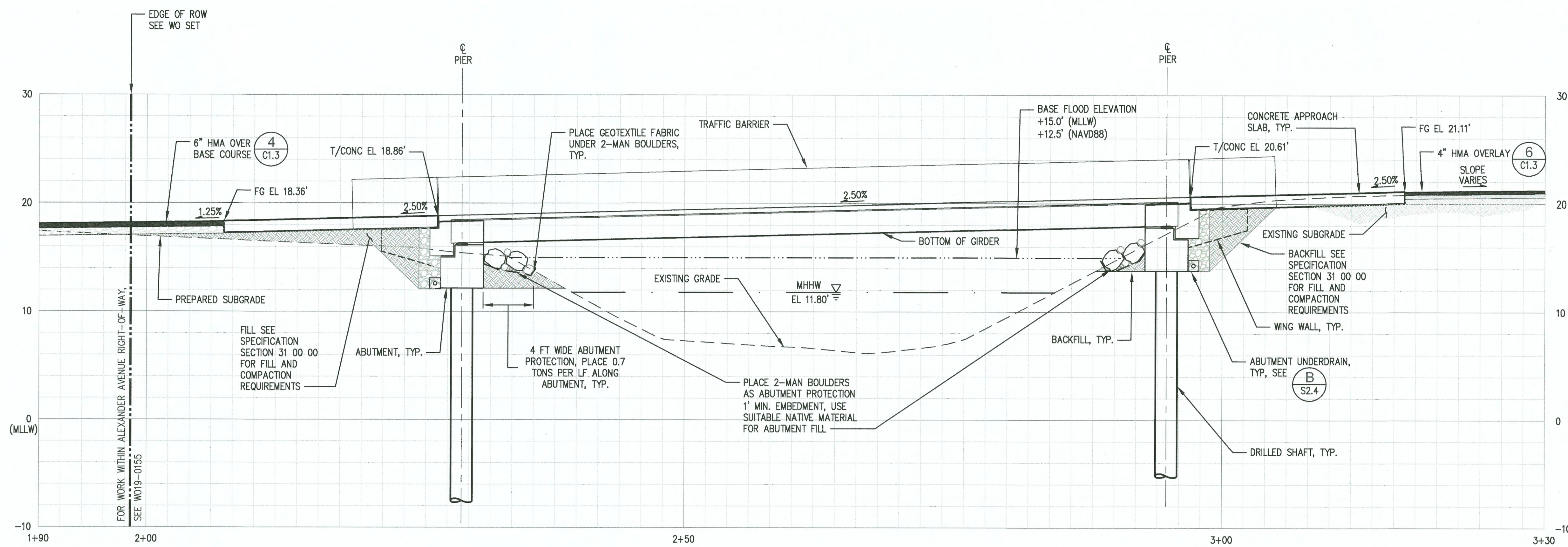

A
C2.1
BRIDGE PROFILE
1" = 5'

<p>6608 C2.3 15 OF 33</p>	<p>WAPATO CREEK BRIDGE AND CULVERT REMOVAL GRADING AND DRAINAGE SECTIONS</p>		<p>APPROVED:</p>	<p>CMB 06/01/20</p>
	<p>CONT/CONS: 071188</p>	<p>RANGE: 03E</p>	<p>SECTION: 01</p>	<p>CHECKED BY: SWK</p>
<p>M. ID: 201070.01</p>	<p>DAT-HRZ: WA63-SF</p>	<p>VERT: MLLW 19.18' @ TIDE 22 1933</p>	<p>PRINTED BY: rhambert Jun 17, 2020</p>	<p>PROJ. ENGR DATE</p>
<p>PHASE: BID SET</p>	<p>PARCEL: 15</p>	<p>DRAWING SCALE: AS SHOWN</p>	<p>PORT ADDRESS: ONE SITCOM PLAZA TACOMA, WA 98401-1837</p>	<p>DATE:</p>
<p>THIS DRAWING IS THE PROPERTY OF THE PORT OF TACOMA AND SHALL NOT BE USED ON OTHER WORK, DISCLOSED, COPIED, IN WHOLE OR IN PART, WITHOUT WRITTEN PERMISSION</p>			<p>MARK: REVISION:</p>	<p>BY: APPR: DATE:</p>



2407 North 31st Street, Suite 100
Tacoma, Washington 98407
(253) 396-0150 Fax (253) 396-0162



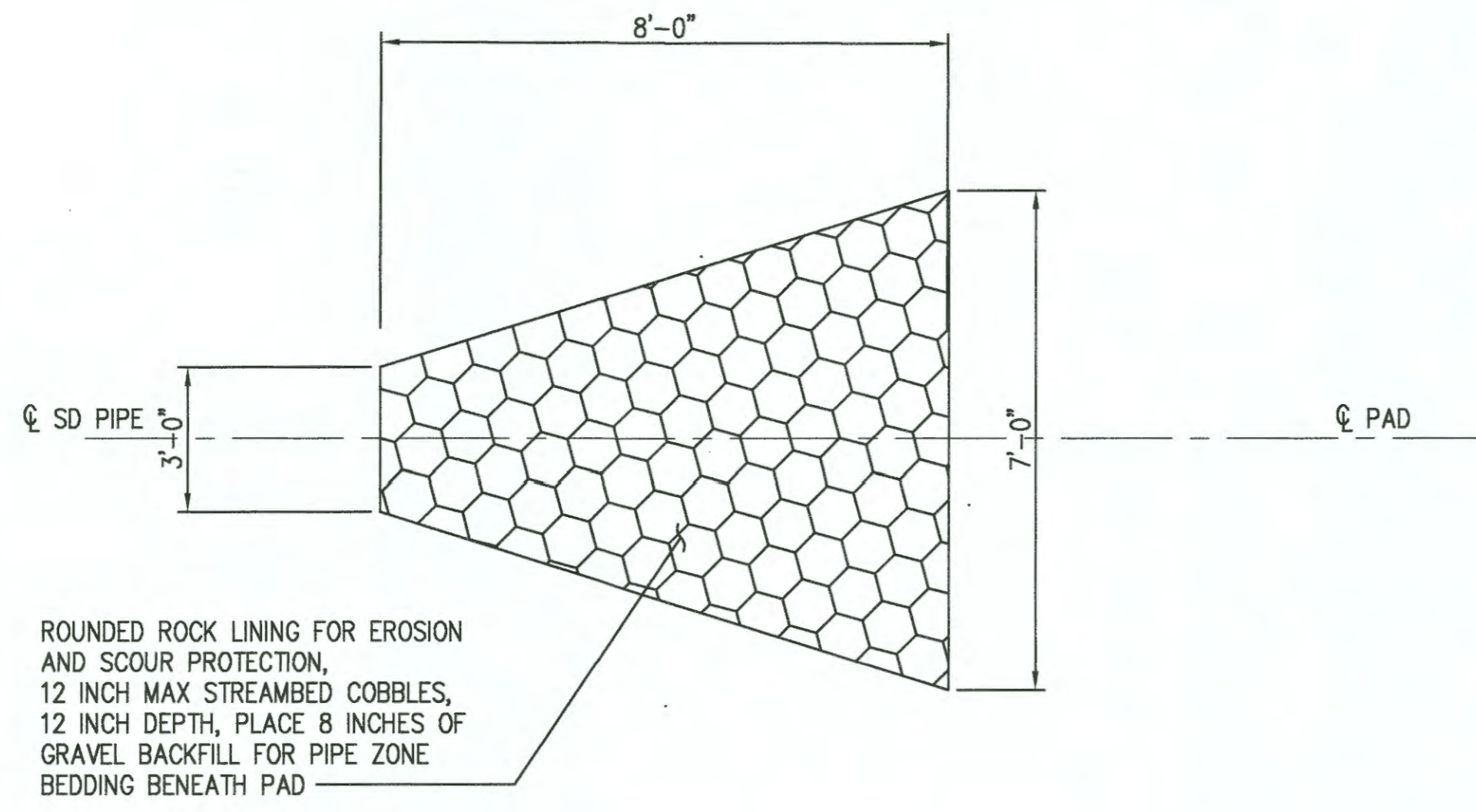

2
ROUNDED ROCK OUTFALL DISPERSION PAD DETAIL
 NOT TO SCALE



3
OUTFALL EXISTING CONDITION PHOTO

REMOVE 3 EXISTING 12" ϕ CONCRETE PIPE LENGTHS, RECONNECT NEW PIPE AND INLINE CHECK VALVE AND RESTORE BANK

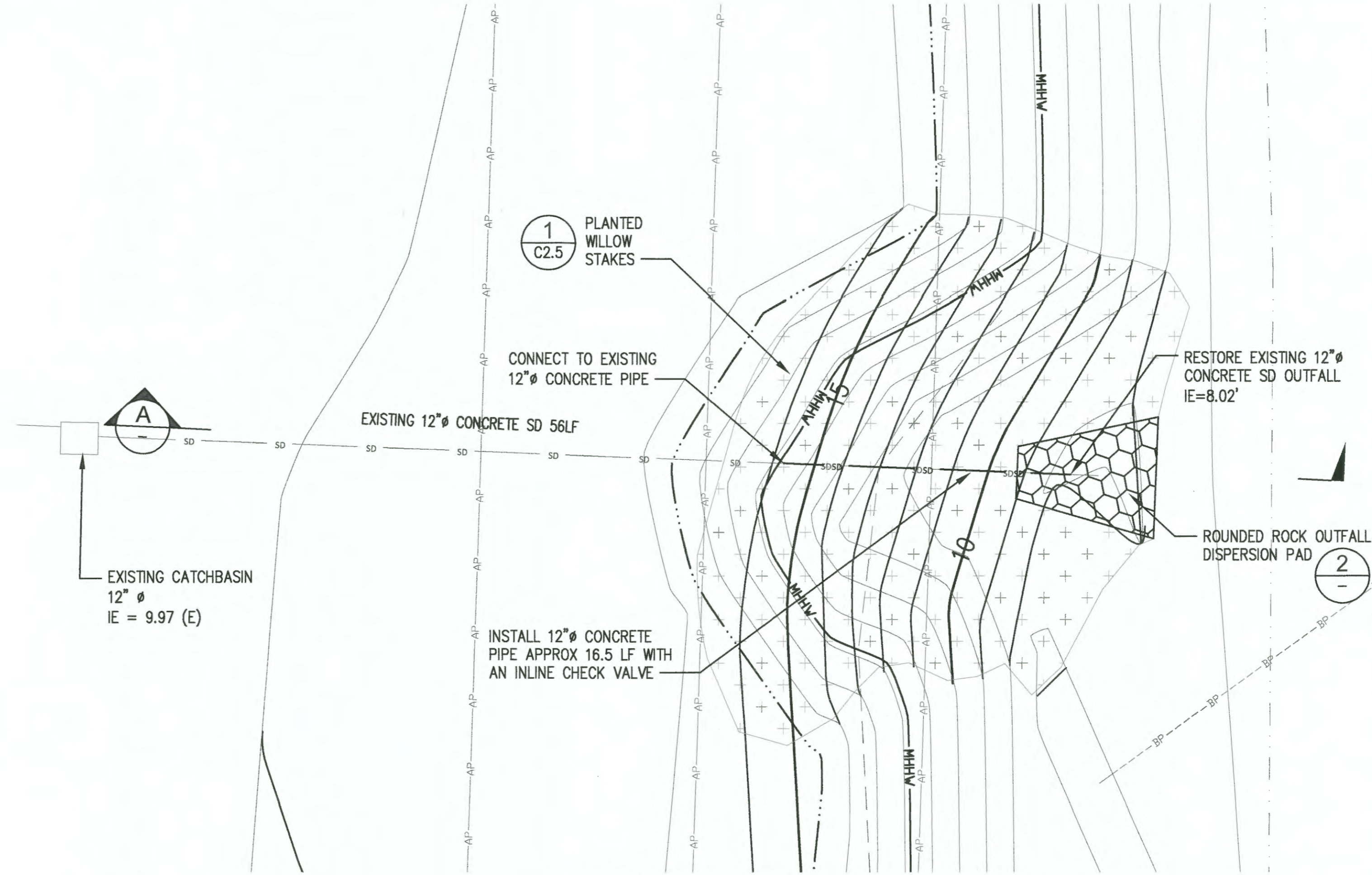

1
EXISTING OUTFALL REPAIR PLAN
 1" = 5'

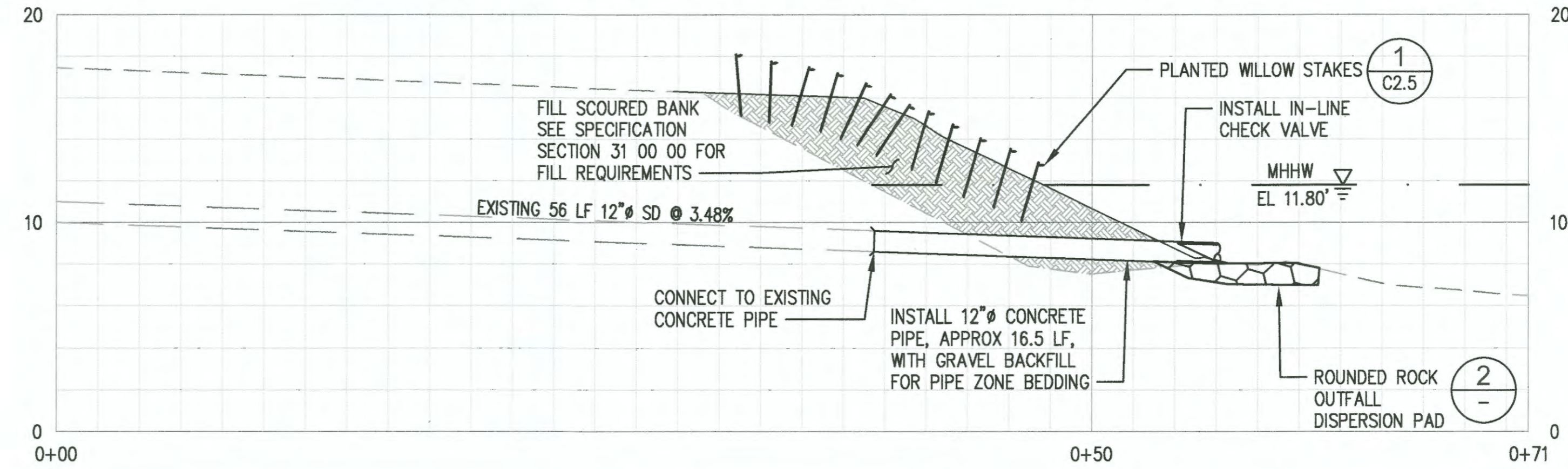

A
OUTFALL PROFILE
 1" = 5'



kpff
 2407 North 51st Street, Suite 100
 Tacoma, Washington 98409
 (253) 396-0150 Fax: (253) 396-0162



APPROVED: [Signature]
 CMB 06/01/20
 CHECKED BY: SWK 06/01/20
 DIRECTOR ENGR. DATE: [Signature] PROJECT ENGR. DATE: [Signature]
 PRINTED BY: rloombert Jun 18, 2020
 PORT ADDRESS: ONE SITCUM PLAZA
 TACOMA, WA 98401-1837

WAPATO CREEK
BRIDGE AND CULVERT REMOVAL
 GRADING AND DRAINAGE DETAILS
 OUTFALL REPAIR
 TOWNSHIP: 20N RANGE: 03E SECTION: 01
 DAT-HRZ: WA83-SF VERT: MLLW 19.18 @ TIDE 22.1933
 PARCEL: 15 DRAWING SCALE: AS SHOWN

6608
C2.4
 16 OF 33
 CONT/CONS: 071198
 M. ID: 201070.01
 PHASE: BID SET

THIS DRAWING IS THE PROPERTY OF THE PORT OF TACOMA AND SHALL NOT BE USED ON OTHER WORK, DISCLOSED, COPIED, IN WHOLE OR IN PART, WITHOUT WRITTEN PERMISSION